

DATED 7th May 2020

PUBLIC PATH EXTINGUISHMENT ORDER

TOWN AND COUNTRY PLANNING ACT 1990, SECTION 258

**BRENT CROSS CRICKLEWOOD REGENERATION PHASE 1 SOUTH (CLAREFIELD PARK)
PUBLIC PATH EXTINGUISHMENT ORDER 2020**

PUBLIC PATH EXTINGUISHMENT ORDER

TOWN AND COUNTRY PLANNING ACT 1990, SECTION 258

**BRENT CROSS CRICKLEWOOD REGENERATION PHASE 1 SOUTH (CLAREFIELD PARK)
PUBLIC PATH EXTINGUISHMENT ORDER 2020**

This order is made by the London Borough of Barnet under section 258(1) of the Town and Country Planning Act 1990, which:

(a) has appropriated for planning purposes the land described in the Schedule to this order ("the Schedule") which is subject to the public footpaths to which this order relates and such land is held by the authority for the purposes for which it was appropriated; and

(b) is satisfied that alternative footpaths are not required.

BY THIS ORDER the public rights of way over the land, being footpaths, and shown by bold black lines on the attached map with reference 23624002-STR-HGN-100-DR-D-01003 Rev P3 ("the Map") and described in the Schedule are extinguished on the confirmation of this order.

SCHEDULE

Description of site of existing path or way extinguished

The following public footpaths are to be extinguished

1. 91 metres of public footpath as shown by a bold black line running between point A and B as indicated on the Map from the south western end of Clarefield Park to the junction with the eastern end of Claremont Way;
2. 110 metres of public footpath as shown by a bold black line running in a northerly direction from the junction with Claremont Way between point C and D as indicated on the Map;
3. 78 metres of public footpath as shown by a bold black line running broadly north east through Clarefield Park between points E and F as indicated on the Map;
4. 46 metres of public footpaths that run opposite the Rosa Freedman Centre as shown by bold black lines running between point D and G on the Map;
5. 101 metres of public footpath as shown by a bold black line running broadly north east through Clarefield Park between points D and H as indicated on the Map; and
6. 49 metres of public footpath as shown by a bold black line running in a broadly southerly direction through Clarefield Park between points H and I as indicated on the Map.

Dated:

7th May 2020



THE COMMON SEAL OF THE MAYOR AND)
BURGESSES OF THE LONDON BOROUGH)
OF BARNET was hereunto affixed in the)
presence of)



Authorised Signatory

A-CHARLWOOD

JFarr Monitoring officer.

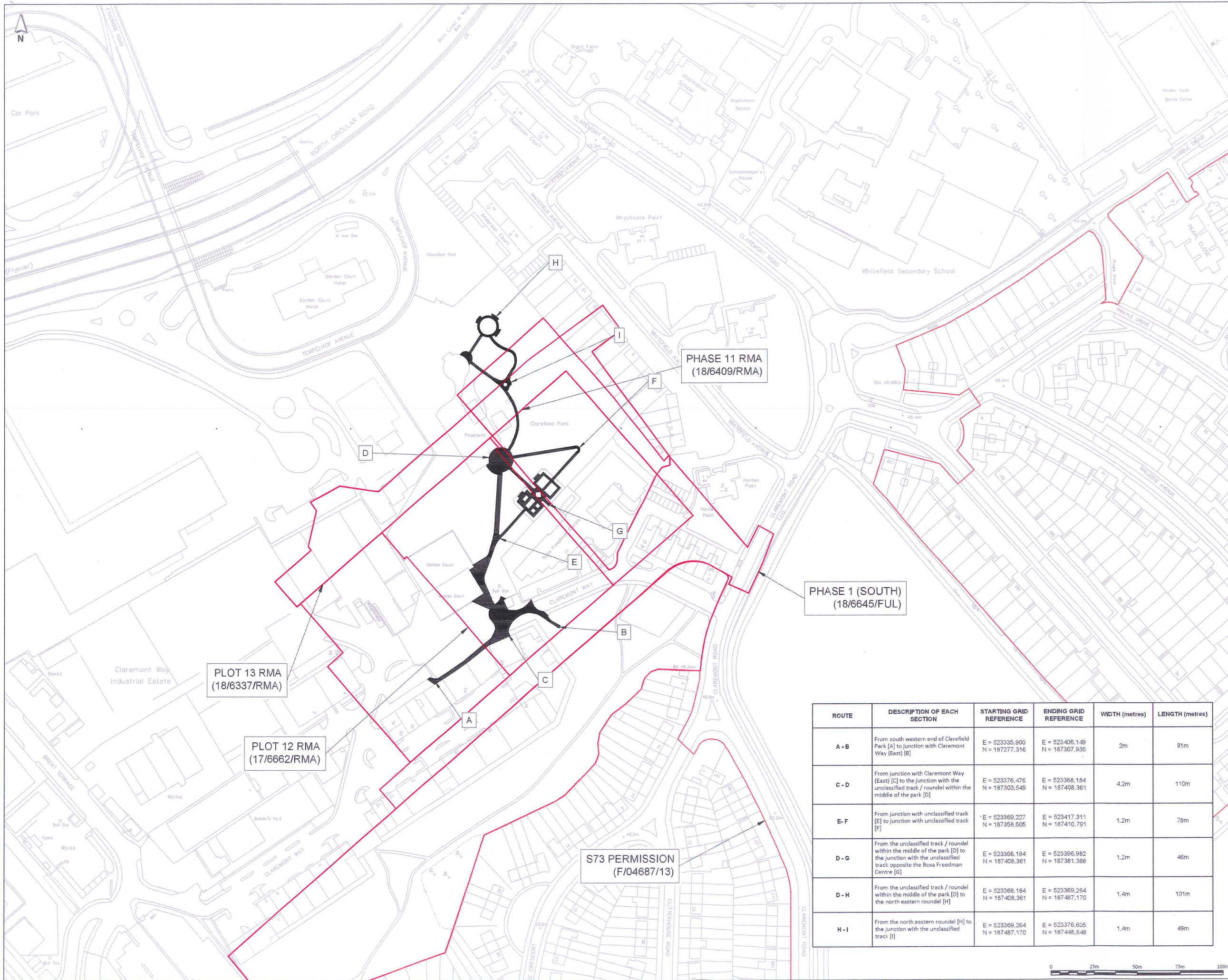

- NOTES:**
1. THIS DRAWING IS TO BE READ IN CONJUNCTION WITH ALL OTHER RELEVANT DOCUMENTATION.
 2. DO NOT SCALE FROM THIS DRAWING. USE ONLY PRINTED DIMENSIONS.
 3. ALL DIMENSIONS, CHAINAGES, LEVELS AND COORDINATES ARE IN METRES UNLESS DEFINED OTHERWISE.
 4. THIS DRAWING IS TO BE READ IN CONJUNCTION WITH THE PROJECT HEALTH & SAFETY FILE FOR ANY IDENTIFIED POTENTIAL RISKS.
 5. NO ADDITIONAL DEFINED FOOTPATHS WERE IDENTIFIED DURING A SITE VISIT ON 18TH SEPTEMBER 2019. REFER TO SUPPORTING PHOTOGRAPHIC RECORD FOR INFORMATION.

- KEY:**
- DEVELOPMENT PLOT BOUNDARIES
 - PUBLIC FOOTPATHS TO BE EXTINGUISHED

Handwritten signature and initials

REV	DATE	DESCRIPTION	DES	CHK	APP
P3	18OCT19	MINOR CHANGES	AAZ	CJM	PVC
P2	03OCT19	STOPPING AREA REDUCED TO FOOTPATHS ONLY	AAZ	CJM	PVC
P1	09SEP19	TABLE ADDED	AAZ	CJM	PVC
P0	15AUG19	ORIGINAL ISSUE	AAZ	CJM	PVC

ROUTE	DESCRIPTION OF EACH SECTION	STARTING GRID REFERENCE	ENDING GRID REFERENCE	WIDTH (metres)	LENGTH (metres)
A - B	From south western end of Clarefield Park [A] to junction with Claremont Way (East) [B]	E = 523335.900 N = 187277.316	E = 523406.149 N = 187307.935	2m	91m
C - D	From junction with Claremont Way (East) [C] to the junction with the unclassified track / roundel within the middle of the park [D]	E = 523376.476 N = 187303.549	E = 523366.184 N = 187408.361	4.2m	110m
E - F	From junction with unclassified track [E] to junction with unclassified track [F]	E = 523369.227 N = 187358.606	E = 523417.311 N = 187410.791	1.2m	78m
D - G	From the unclassified track / roundel within the middle of the park [D] to the junction with the unclassified track opposite the Rosa Freedman Centre [G]	E = 523366.184 N = 187408.361	E = 523396.982 N = 187381.386	1.2m	46m
D - H	From the unclassified track / roundel within the middle of the park [D] to the north eastern roundel [H]	E = 523366.184 N = 187408.361	E = 523369.264 N = 187487.170	1.4m	101m
H - I	From the north eastern roundel [H] to the junction with the unclassified track [I]	E = 523369.264 N = 187487.170	E = 523376.605 N = 187448.648	1.4m	49m

steer

Client: BRENT CROSS SOUTH LIMITED PARTNERSHIP

Project Title: BRENT CROSS SOUTH

Drawing Title: CLAREFIELD PARK PROW TO BE EXTINGUISHED (S258)

Status: WORK IN PROGRESS

Size: A1 Scale: 1:1000 Suitability: S0 Rev: P3

Drawing No. 23624002-STR-HGN-100-DR-D-01003



BASED UPON ORDNANCE SURVEY'S MAPS WITH THE PERMISSION OF THE CONTROLLER OF HM.LD. AS CROWN COPYRIGHT. UNAUTHORISED REPRODUCTION INFRINGES CROWN COPYRIGHT AND MAY LEAD TO PROSECUTION OR CIVIL PROCEEDINGS. 100658248