



211_1D_05_01

211_1D_05_01

211_1D_05_01

1 Block 1D_Ground Floor Plan
1 : 200

Room Legend

- 3 Bed Duplex
- Bed 1
- Bed 2
- Bicycle parking
- Bin Storage
- Core
- Electrical Room

CARPARKING SPACES:	MOTORBIKE SPACES:
STANDARD SPACES: 100	
TOTAL SPACES: 100	TOTAL SPACES: 12

REV.	DATE:	DETAILS:	INITIALS:

NORTH POINT:

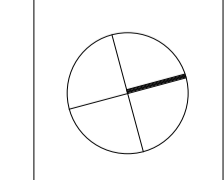

KEY PLAN:

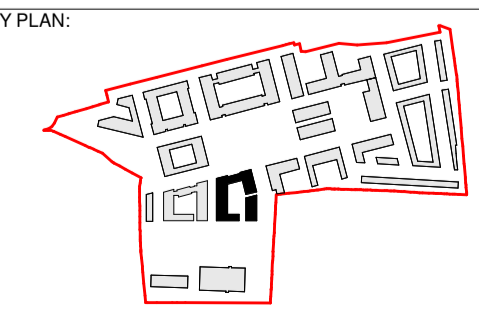

PLUSARCHITECTURE

PROJECT: North London Business Park
CLIENT: The Comer Group
TITLE: Block 1D_Ground Floor Plan
ISSUE TYPE: Planning

Chancery Lane, Dublin 8, Ireland. W: www.plusarchitecture.ie T: 353 (0) 1 521 3378

PROJECT: 211
DRAWING NO.: 211_1D_02_00
DRAWN BY: JG
CHECKED BY: DT
DATE: 21/06/2021
REVISION NO.:
SCALE AT A1 : 1 : 200
SCALE AT A3 : 1 : 200

Copyright of this drawing is vested in the architect and a report not be copied or reproduced without consent. Figures dimensions only are to be taken from this drawing. All contractors must visit site and be responsible for setting and checking all dimensions relative their work. PLUS Architecture are to be advised of any variation between drawings and site conditions. DO NOT SCALE OFF THIS DRAWING. ... or its content.